

Hotel Republic features 12 meeting rooms totaling more than 12,000 SqFt of flexible indoor and outdoor event space. Ideal for social and corporate events, Hotel Republic San Diego offers unique and artfully crafted menus. All of your audio visual needs are handled by our in-house providers, AVMS.

## CAPACITY CHART

MEETING ROOM	DIMENSIONS		CAPACITY							
	LxWxH	SQFT	THEATER	CLASSROOM	CONFERENCE	U-SHAPE	RECEPTION	BANQUET	CRES RND	HOLLOW SQR
<b>GRAND &amp; SALON</b>	81x26x11	2,244	293	183	72		225	150	75	
Grand	51x34x11	1,734	242	150	48	51	180	120	60	60
Grand Patio	68x12	816					75	50		
Salon	30x17x11	510	51	33	24	21	45	30	15	24
Salon Patio	18x12	216					50	20		
Grand Patio & Salon Patio	86x12	1,032					125	70		
<b>GREAT &amp; STUDIOS</b>	99x25x9	2,530	284	177			230	180	90	
Great	59x30x9	1770	212	123	42	45	150	120	60	54
Studio 1	20x19x9	380	36	24	18	15	40	30	15	18
Studio 2	20x19x9	380	36	24	18	15	40	30	15	18
Studio 1 & 2	40x19x9	760	72	48	36	30	80	60	30	36
<b>INDUSTRY 1-4</b>	106x24x9	2,490	288	189			215	180	90	
Industry 1	25x21x9	525	71	36	21	21	45	40	20	24
Industry 2	37x21x9	777	93	60	33	33	75	60	30	36
Industry 3	22x30x9	660	68	33	18	18	60	40	20	24
Industry 4	22x24x9	528	56	42	18	15	35	40	20	18
Industry 1 & 2	62x21x9	1,302	164	96	54	54	120	100	50	60
Industry 2 & 3	59x26x9	1,437	161	93	51	51	135	100	50	60
Industry 3 & 4	44x27x9	1,188	124	75	36	33	95	80	40	42
Industry 1-3	84x24x9	1,962	232	129	72	72	180	140	70	84
Industry 2-4	81x25x9	1,965	217	135	69	66	170	140	70	78
<b>VERANDA CLUB &amp; DECK</b>	61x32	1,960	215				155	130	65	
Veranda Club	25x28x10	700	74	48	18	21	50	50	25	24
Veranda Deck	36x35	1260	141				105	80	40	
<b>TOPSIDE</b>	84x25	2,060	228				160	140	70	
Topside West	44x25	1,100	102				60	80	40	
Topside East	40x24	960	126				100	60	30	



## FLOOR PLANS

FIRST FLOOR

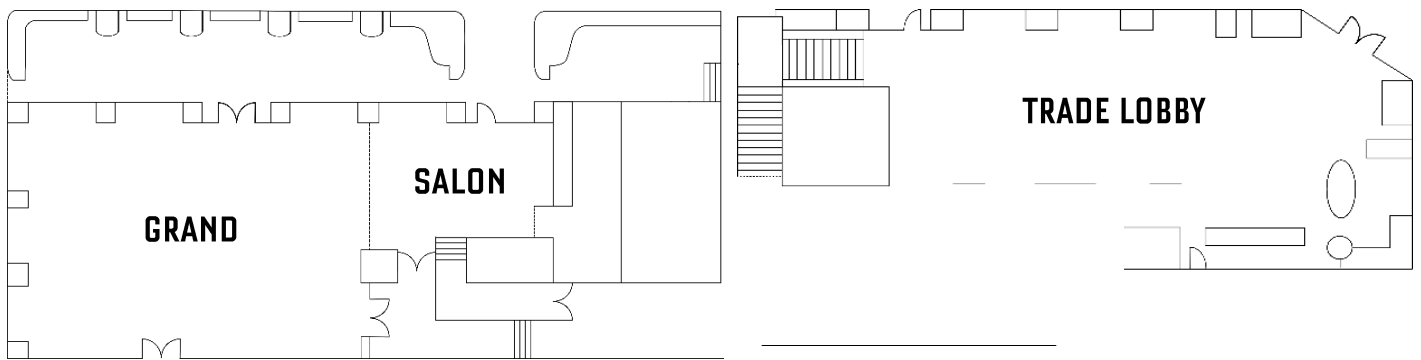

SECOND FLOOR

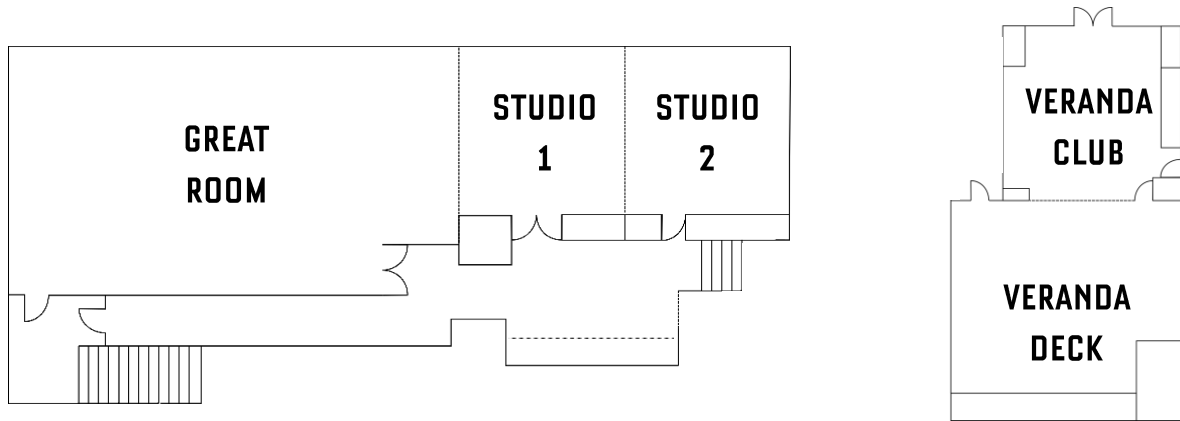

THIRD FLOOR

